

信仰者 *Believer*

用户手册 v3.0

User ManualV3.0

2026.03

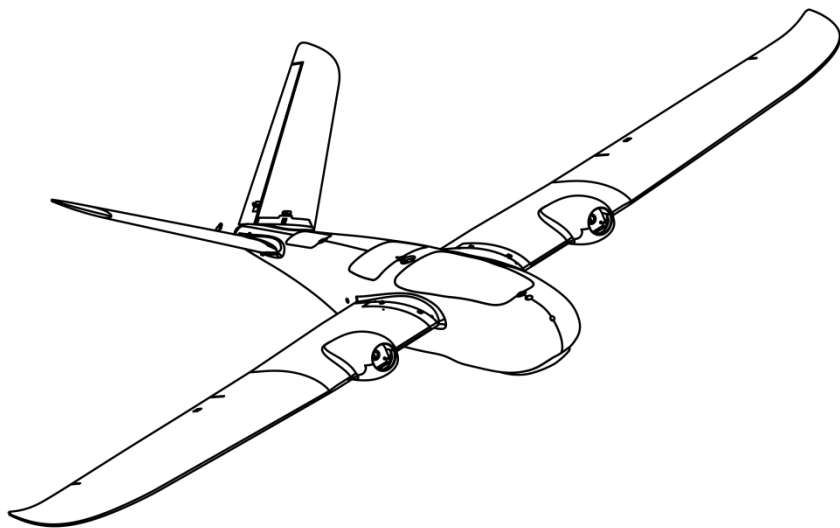

产品概述 Product Overview

简介 Introduction

信仰者是一款手抛固定翼飞机机壳，具有携带易用，操作友好，稳定耐用等特点。整机模块化设计让飞行前的组装工作简单快捷，可快拆机翼、可快拆尾翼、机腹减震释能使飞机具有良好的便携性和优异的用户体验。

The Believer is a hand-launched fixed-wing airframe. It is portable, easy to operate, stable and durable. The fully modular design enables quick and hassle-free pre-flight assembly. Featuring quick-detachable wings and empennage, plus belly shock absorption structure, this airframe boasts great portability and an outstanding user experience.

免责声明 Disclaimer

Makeflyeasy 系列产品为通用航模/无人机零配件，任何理由引起的直接，间接衍生性意外伤害造成的后果，厂家不承担任何责任。

禁止用于军事相关用途，禁止用于涉密及违禁飞行场景，严禁擅自闯入机场、军事管理区、禁飞区飞行，使用者承担全部飞行责任。

请把飞行器放置儿童触及范围之外，确保飞行器飞行时远离人群及危险物品，切勿在饮酒，疲劳或精神不佳情况下进行任何飞行器操作。

All products of the Makeflyeasy series are general model aircraft and UAV spare parts. The manufacturer shall not be held liable for any consequences arising from direct, indirect or consequential personal injury caused by any reason.

This product is prohibited for military-related purposes, confidential operations and prohibited flight scenarios. Unauthorized flight into airports,

military restricted areas and no-fly zones is strictly prohibited. The end user shall bear full responsibility for all flight activities. Keep the aircraft out of the reach of children. Always operate it away from crowds and hazardous objects. Do not operate the aircraft under the influence of alcohol, when fatigued, or in poor mental condition.

产品规格

材质：EPO、EVA、碳纤维、工程塑料等	
翼展：1960mm	机身高：180mm
机身长：1070mm	翼面积：51.4dm ²
推荐飞行速度 20m/s	失速速度 10m/s
最大起飞重量 5.5kg	

Products specifications:

Materials :EPO, EVA, carbon fiber, engineering plastics and etc.

Wing span: 1960mm	fuselage height: 180mm
-------------------	------------------------

fuselage length: 1070mm	Wing area:51.4dm ²
-------------------------	-------------------------------

Suggested flying speed: 20m/s	Stalling speed: 10m/s
-------------------------------	-----------------------

Max. Takeoff weight:5.5kg

产品使用注意事项 Products operating attentions

安装注意 Installing attentions

1. 在焊接大电流连接器时，一定要注意焊接线序要相互对应，以免烧毁电调、舵机。

1 Pay attention to the welding wires sequence which should be corresponding to each other during the welding of large current connector. Or maybe the electric regulator and servo suffered burning-out.

2. 推荐使用 **MFE 3054** 数字舵机，或者其他相同尺寸的舵机及圆盘舵角，便于舵机安装，和尾翼快拆装置的安装。

2 We recommend the **MFE 3054** metal digital servo, or other same size servo and round board helmangle for the easy installing of servo and tail wings quick release devices.

3. 起飞重量大于 4.5kg 情况，需要用户自己加强机翼和尾翼。

3 Stiffening the wings and empennages when the takeoff weight was more than 4.5kg.

4. 安装顺序请参考信仰者组装流程图。

4 Please refer to the Believer assembly flow graph when you were confused by the Installing sequence.

飞行注意 Flying Attentions

1. 请避免在 10m/s 以下的速度飞行转弯，以免飞机失速。

1 Don't cornering when the aircraft flying speed was less than 10m/s, or the aircraft maybe stalling.

2. 飞行前请务必检查电机、螺旋桨安装正确稳固，电调信号线和电源线插头连接坚固可靠。

2 Ensure the motor and propeller were installed correctly and toughly before flying, inspecting the electronic regulating signal wires and power lines plug, ensure they were connected toughly.

3. 飞行时请远离不安全因数，如障碍物、人群、儿童、建筑物、高压线等。

3 Away from the unsafety facors such as barrier, crowd, children, buildings, high-voltage wires and etc while flying.

4. 务必在安全起飞重量下飞行，切勿在机场净空区范围飞行。
- 4 Takeoff under the safety weight and never flying in the area of airfield clearance zone.
5. 切勿贴近或接触旋转中的电机或螺旋桨，避免被旋转中的螺旋桨割伤。
- 5 Don't get too close to the rotating motor or propeller, avoid to the possible cuts.
6. 请按标识重心位置配重（位于机翼翼根塑料件下突起处）
- 6 Conduct the counterweight at the marked center of gravity position. (At the protrusion which was under the plastic parts of wings root)

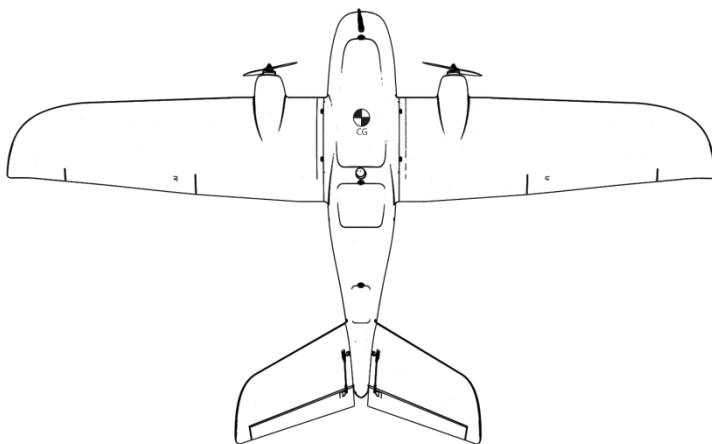

盒内物品清单 Contents in the box

EPO 部件 EPO Parts

1 左右机翼 1 left & right wing

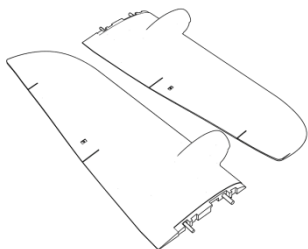

2 左右尾翼 2 left & right empennage

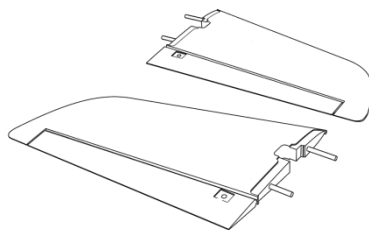

3 左右机身 2 left & right fuselage

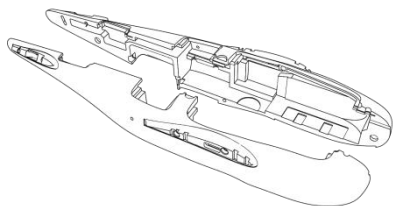

4 机翼盖板 4 Wings covering plate

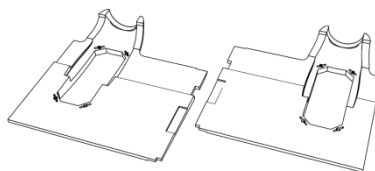

5 机舱盖 5 Cabin cover

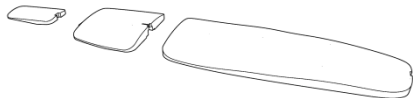

6 伞舱盖 6 Parachute cabin cover

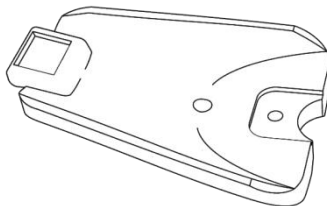

碳管部件 Carbon tube parts

1 机身支撑碳管

- 1 Fuselage supporting carbon tube
14*12*206mm
12*10*206mm



2 机翼对插碳管

- 2 Wings inserting carbon tube
12*10*700mm
10*8*600mm

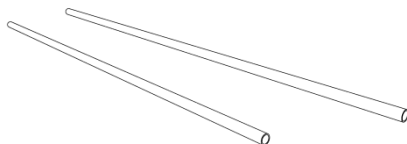

塑料件 Plastic parts

1 机翼连接件*2

- 1 Wings connecting parts*2

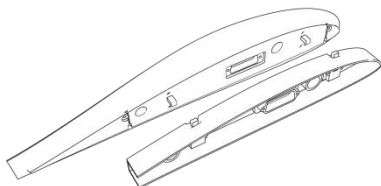

2 尾翼连接件*2

- 2 Empennages connecting parts*2

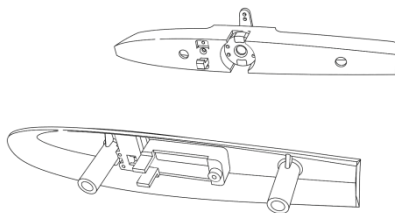

3 舵机固定件*2

- 3 Servo fixing parts*2

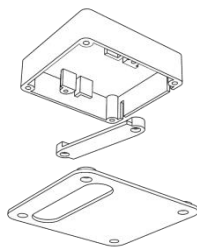

舵机安装座

servo installing base

舵机压片

servo presser

舵机盖板

servo covering plate

4 舵角*4

- 4 Helmangle *4

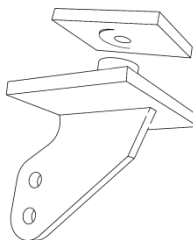

5 电池固定板*1

5 Battery fixing board*1

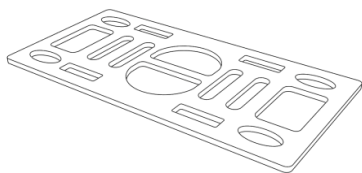

6 天线固定板*2

6 Antenna fixing board*2

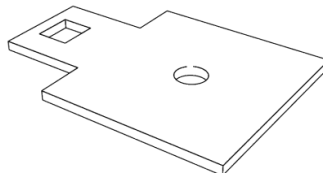

7 舱盖固定板*1

7 Cabin cover fixing board*1

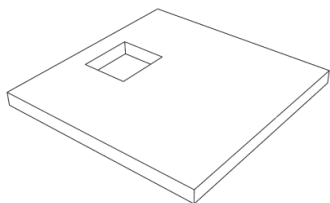

8 电调盖板*2

8 Electric regulating cover*2

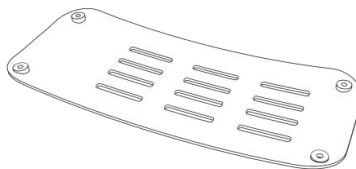

9 螺丝柱*12

9 Stud*12

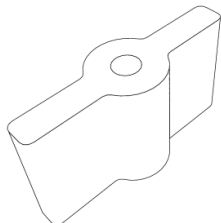

10 舱盖锁钉*3

10 Cabin cover locking nail*3

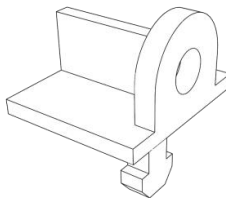

11 卡盘*2

11 Chuck*2

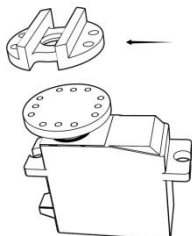

12 锁钩*8

12 Latching hook

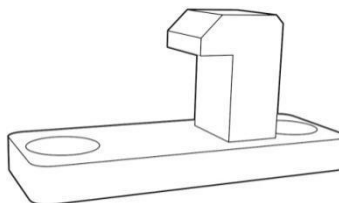

木板部件 Wooden parts

1 机身加强层板*2

1 Fuselage reinforcing plate*2

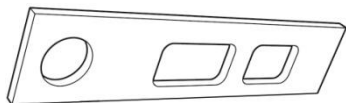

2 机尾加强层板

2 Tail reinforcing plate

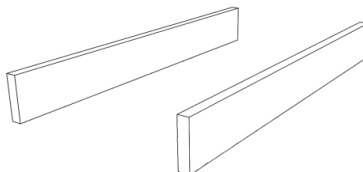

3 飞控放置板*1

3 Autopilot locating board*1

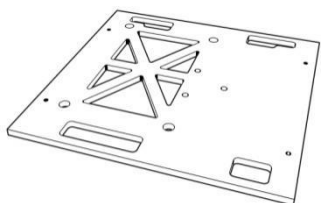

4 伞舱舵机座*1

4 Basement of parachute servo*1

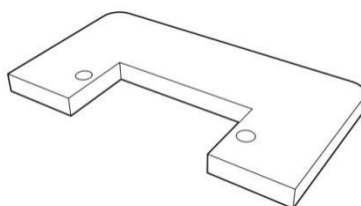

5 伞舱盖木板*1

5 Wooden plate of parachute hatch cover*1

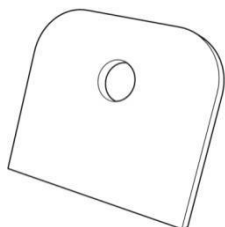

6 伞舱盖加强板*1

6 Stiffer of parachute hatch cover *1

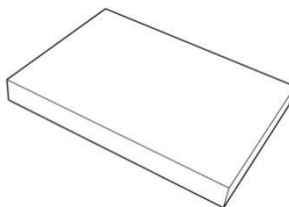

7 电机安装座

7 Motor installing base

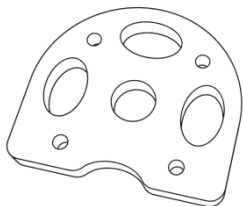

EVA 部件 (电池区缓冲垫、飞控区缓冲垫)

EVA parts(Cushion at battery area, cushion at flight control area)



其他配件 Other fittings

序号 NO.	名称及型号 Name & Model	数量 Qty	备注 Notes
1	大电流连接器 Large electronic current connector	2 套 2 groups	
2	尾翼舵机延长线 30cm Empennage servo extending wire	2 根 2 sets	
	舵机单端公头延长线 30cm Servo single-head male connector extending wire 30cm	2 根 2 sets	机翼部分 Wing section
	机身油门舵机单端母头延长线 30cm fuselage fuel gate servo single-head female connector extending wire 30cm	4 根 4 sets	机身部分 fuselage section

	副翼/油门 Y 线 10cm Aileron/Fuel gate Y wire 10cm	2 根 2 sets	
3	16AWG 硅胶线 (黑) 16AWGSilicone wire (black)	1 米 1 m	
	16AWG 硅胶线 (红) 16AWGSilicone wire (red)	1 米 1 m	
4	热缩管直径 2.5mm*15mm Diameter of heat shrink tubing 2.5mm*15mm	20 段 20 sections	
	热缩管直径 6mm*15mm Diameter of heat shrink tubing 6mm*15mm	12 段 12 sections	
5	束线管 Wire harness tube	1 米 1m	
	魔术扎带 Magic tie straps	2 根 2 sets	与电池固定板搭配使用 Matching the battery fixing board
6	透明泡沫胶 Transparent foam glue	2 支 2 PCS	
7	球头 Ball head	8 个 8PCS	球头连杆 Ball link rod
	连杆 Link rod	4 根 4 sets	球头连杆 Ball link rod
	圆头螺钉 M2X10 Button head screw M2X10	8 颗 8PCS	球头连杆 Ball link rod
	防松螺母 M2 Block nut M2	8 颗 8 PCS	球头连杆 Ball link rod
8	塑料锁扣 Plastic latch	3 个 3PCS	舱盖锁定 Hatch cover locking nail
9	断尾圆头螺丝 M2.5X8 Tail button head screw M2.5X8	10 颗 10PCS	大电流连接器、伞舵机 Large electronic current connector, parachute servo
10	断尾圆头螺丝 M2X10	8 颗	舵机压片、飞控放置板

	Tail button head screw M2X10	8PCS	Servo presser, autopilot locating board
11	断尾圆头螺丝 M2X8 Tail button head screw M2X8	34 颗 34PCS	机翼舵角、尾翼舵角、锁钩、电调盖板、舵机盖板 Wing helmangle, empennage helmangle, latching hook, electrically controlled cover plate, servo covering plate
12	带垫螺钉 M3X8 Screws with pad M3*8	8 颗 8PCS	用于固定电机 Fixing the electric motor

辅助安装工具和材料 (自备)

Auxiliary installation tools and materials (Self-contained)

工具 Tools	用途 Usage
3.0mm 十字螺丝刀 3.0 Philips screwdriver	安装螺丝 Installing the screws
电烙铁、焊锡丝 Electric iron, solder wire	焊接电源、舵机线 Welding the power line and servo line
打火机 Lighter	固定热缩管 Fixed heat shrink tube
小刀 Knife	剥线 Wire stripping tool
纸胶、透明胶、纤维胶带(Transparent) adhesive tape, fabric adhesive tape	飞机粘合辅助定位、飞机局部加强 Aircraft bonding and auxiliary positioning, local reinforce

配件包清单图 List of accessories

Number 01 to 21

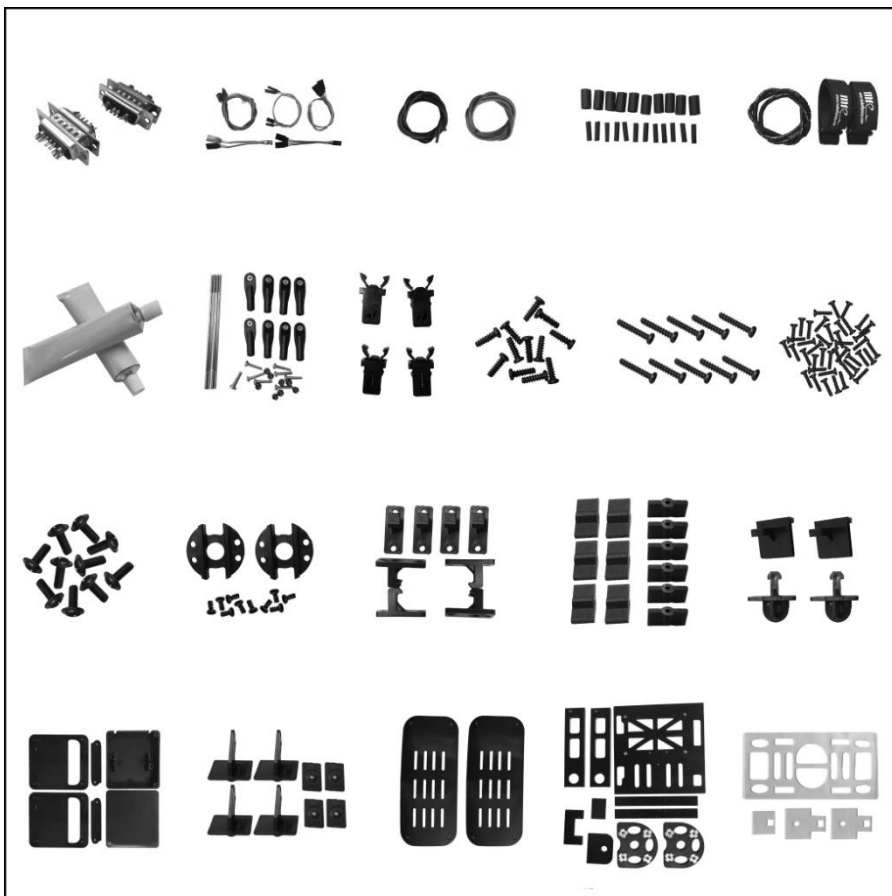

联系我们 Contact Us



微信公众号



bilibili



YouTube



Facebook

网址 (URL) : www.makeflyeasy.com

邮箱 (Email) : makeflyeasy@qq.com

地址 (Site) : 中国绵阳涪城区西南科大国家大学科技园

Southwest University of Science and Technology Park,

Fucheng District, Mianyang, China